

Large Formal Motorised stages¹

- HI16/2-8
- HE16/2-8
- HI05NL/2
- HE05NL/2

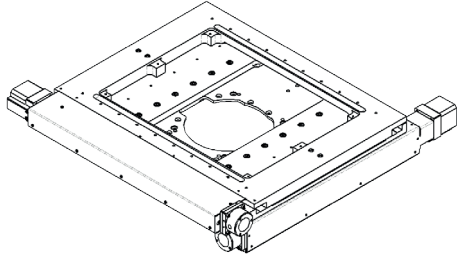

Sample holders for large format stages

- H225 (HI16)
- H232 (HI16)
- HWC20S (HI16)
- HWC20V (HI16)
- HWC15SNL (HI05)
- HWC15VNL (HI05)
- H231 (HI05)
- H227 (HI05)

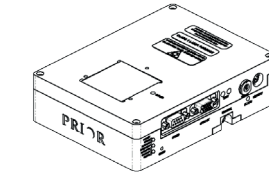
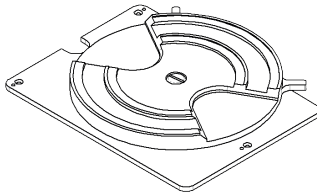

- Laser Autofocus
- LF210
 - LF100K
 - LF320

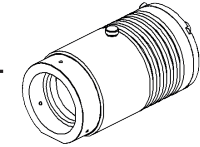

- Brightfield
- LDB101FNI
 - LDP100FNI

Controllers

- ES10ZE
 - V31XYZE
 - V31F
 - V31XYZEF
- Compatible with most imaging software

Large Formal Motorised stages¹

- HI12/2ST
- HE12/2ST

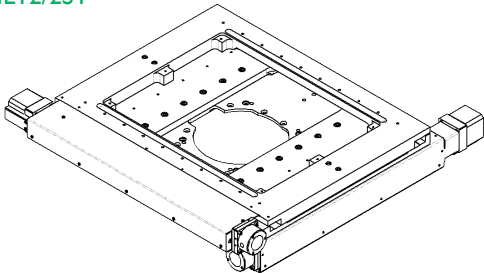

L300 ONLY

Sample holders for large format stages

- H223 (HI12)
- H223 (HI12)
- H223B (HI12)
- HWC30V (HI12)

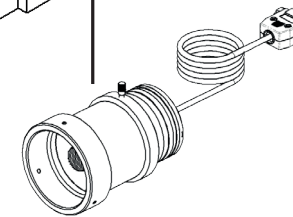
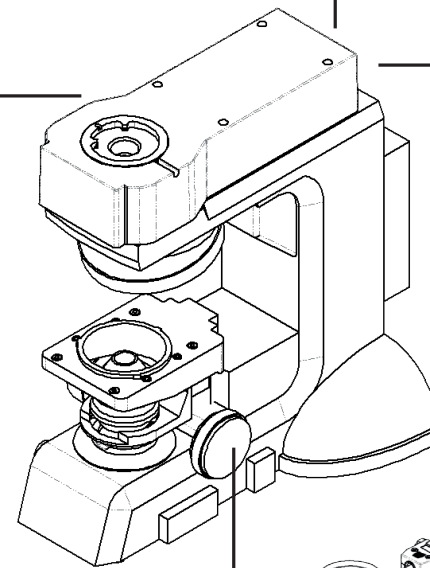
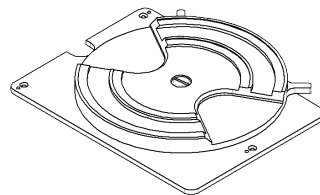

- Focus Motor
- PS3HI22R/H3909



- Joystick Control Unit
- PS3J100

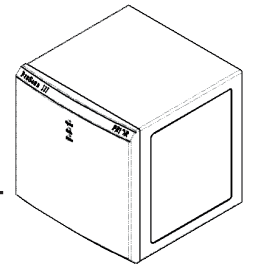



NIKON METROLOGY STRATEGIC PARTNER

Product	Details
ES10ZE	Focus only controller
HI12/2ST	Stage with 300 x 300 mm travel range and 2 mm ball screw
HE12/2ST	As above with encoders
HI16/2-8	Large format stage with 255 x 215 mm travel range, 200 stepper motor and 2 mm screw pitch
HE16/2-8	As above with encoders
H221	Glass Plate (HI12 stages) - not suitable for transmitted microscopy
H225	Glass plate (HI16 stages) - not suitable for transmitted microscopy
H233	Aluminium plate (HI12 stages)
H233B	Aluminium plate with M4 and M6 tapped holes (HI12 stages)
H232	Aluminium plate (HI16 stages)
H227	Glass plate (HI05 stages) - not suitable for transmitted microscopy
H231	Aluminium plate (HI05 stages)
H3909	Focus Motor Adapter for Nikon LV series and L200
HWCI5SNL	Wafer chuck for 100 and 150 mm wafers (HI05 stages)
HWCI5VNL	Wafer chuck, rotatable with vacuum for 150 mm (HI05 stages)
HWC20S	Wafer chuck for for 150 mm and 200 mm wafers (HI16 stages)
HWC20V	Wafer chuck, rotatable with vacuum for 200 mm wafers (HI16 stages)
HWC30S	Wafer chuck, rotatable, for 300 mm wafers (HI12 stages)
LDB100FNI	Brightfield Illumination LED for Nikon (controlled by ProScan)
LDB101FNI	Brightfield Illumination LED for Nikon (stand alone)
LF100K	LF210 Digipot and Keypad
LF210	Laser AutoFocus (requires flange and keypad)
LF320	LF210 Mounting flange for Nikon Microscopes
PS3HI22R	Generic Focus Drive with rotating cable system to prevent twisting
PS3J100	Multifunctional manual joystick for ProScan
V31F	ProScan® controller with three stepper drives for focus and two filter wheels or 3 shutters
V31XYZE	ProScan® controller with XYZ drives and encoder input
V31XYZEF	ProScan® controller with XYZ drives, three filter wheel drives, shutter drives and encoder input

NIKON L200 L300 SYSTEM CHART

If you have a L200 or L300 microscope then this sheet can be used to specify the exact part numbers needed to build up your system. **Not every compatible Prior product is listed here - therefore do not hesitate to contact Prior if you require more assistance, advice or support.**

Please note that this is only a guide, and whilst every effort has been made to ensure it is correct and updated, we highly recommend you consult a Prior sales manager before ordering.