

## Manual Ryf Remote Control for R-FHD-1080

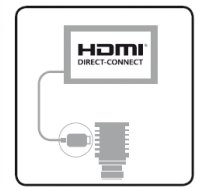

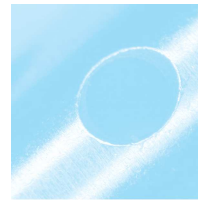

# Manual Ryf Remote Control for R-FHD-1080

Ryf no.	Beschreibung // Description
R-FHD-1080-1001	Digitale High Definition HD Video-Farbkamera in FHD 1080 P Video Standard, HDMI Stecker, robuste Bauweise für die Makroskopie und Mikroskopie, kein PC erforderlich, kompatibel mit Monitoren mit HDMI Schnittstelle. Caméra vidéo couleur FHD haute définition, HD1080 P vidéo standard, connecteur HDMI, construction robuste pour la macroscopie et la microscopie, sans PC, compatible avec moniteurs avec interface HDMI.
R-HD-720-1003	Kabelgebundene Fernbedienung für OSD-Menü zu R-FHD-1080-1001. Télécommande pour contrôle du menu OSD de la caméra R-FHD-1080-1001.
R-HD-720-1004	Stecker-Netzgerät 100-240VAC/12VDC mit Hohlstecker zu R-FHD-1080-1001. Alimentation 100-240VAC/12VDC avec fiche DC pour la caméra R-FHD-1080-1001.

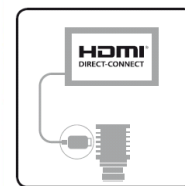
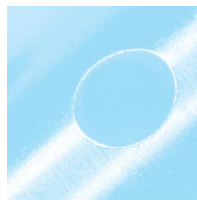

# Manual Ryf Remote Control for R-FHD-1080

## I. Keypad Layout and Button Functions

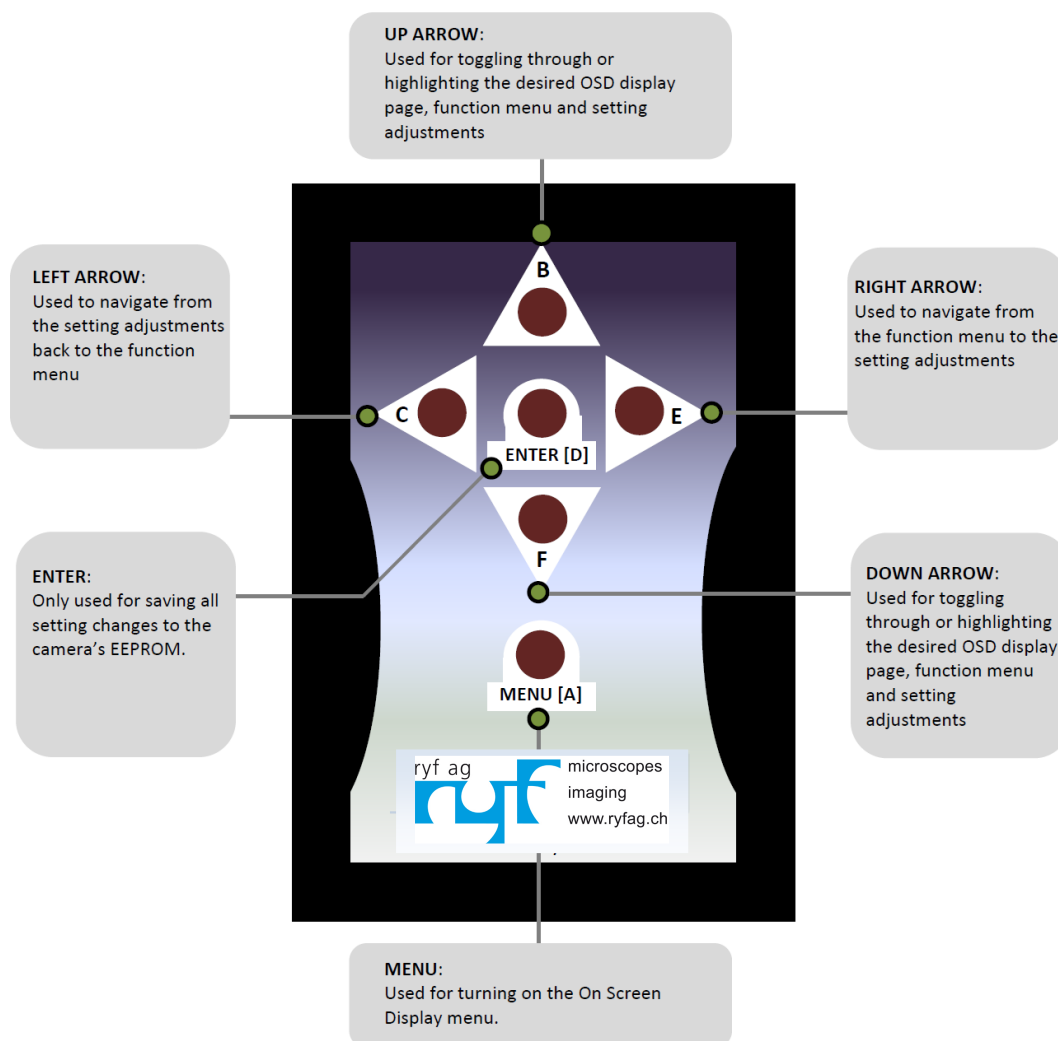

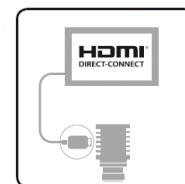
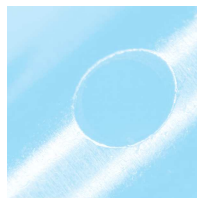

# Manual Ryf Remote Control for R-FHD-1080

## II. Operating the Menu of the Ryf OSD Remote Control (default settings)

First plug in the pin jack of the remote control into the R-FHD camera to begin using the R-FHD-1080 Remote Control unit. Press the MENU (A) buttons to initiate the OSD (on screen display) menu.

Press the **UP [B]** or **DOWN [F]** button to toggle through the function menu and the page numbers.

**NOTE:** In order to change page numbers, the user must toggle through the entire function menu until the appropriate page number is attained.

To adjust a function setting, highlight the function that is to be changed. Press the **RIGHT ARROW [E]** button to highlight the existing function setting. Then press the **UP [B]** or **DOWN [F]** button to toggle through the available setting options for the function. Once the desired setting adjustment is highlighted, simply push the **LEFT ARROW [C]** button to return to the function menu. **NOTE:** It is not necessary to press the **ENTER [D]** button to save the settings adjustment.

When all of the desired setting adjustments are made, toggle to Page 5 of the OSD menu. At the EEPROM function press the **RIGHT ARROW [E]** button to highlight SAVE. Push the **ENTER [D]** button and a prompt will appear on the screen. If you want to save all the setting changes to the EEPROM of the camera press the **ENTER [D]** button again. If you are not ready to save all of the setting changes to the EEPROM press the **LEFT ARROW [C]** button to return to the function menu.

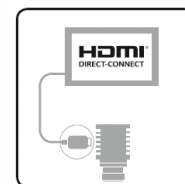
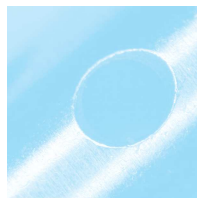

# Manual Ryf Remote Control for R-FHD-1080

## II. Function Menu & Settings Chart

The following chart presents all of the selectable functions and the correlating selectable setting adjustments for each function. For further details on the function menu and the setting please refer to the Ryf camera manual.

DISPLAY PAGE	FUNCTION MENU	SETTING ADJUSTMENT	RANGE
1	ALC	• ON	
		• OFF	
	GAIN	• AUTO	000-255
		• FIXED	000-511
	SHUTTER	• AUTO	000-255
		• FIXED	000-690
	GAMMA	• PRESET (default)	
		• .30	
		• .45	
		• .50	
		• .60	
		• .70	
		• .80	
		• .90	
• 1.0			
OFFSET		000-127	
CONTRAST		000-128 (default 128) <i>(the range limit can be adjusted via the HD133Ctrl software to a maximum of 255)</i>	
SHARPNESS	• H	0-15	
	• V	0-15	
	• Coring	0-63	
MIRROR	• ON		
	• OFF		
2	WB	• MANUAL	R 000-1023 G 000-1023 B 000-1023
3	GRAPHICS	• ON	
		• OFF	
	LINE	• ON	H POS: 000-720 SIZE: 000-720 COLOR: Black, White, Red, Green, Blue, Cyan V POS: 000-1280 SIZE: 000-1280 COLOR: Black, White, Red, Green, Blue, Cyan
	SHADOW	• ON	GRADE: 000-255 H T: 000-719 H B: 000-720 V L: 0000-1279 V R: 0000-1280
• OFF			
4	FPS	• 50	
		• 59.94	
		• 60	
	OSD SIZE	• LARGE	
		• SMALL	
	PROFILE	• PRESET	00-27
	PATTERNS (COLOR BAR)	• OFF	
• GRAY			
• COLOR			
	• GRAY + COLOR		
5	EEPROM	• SAVE	

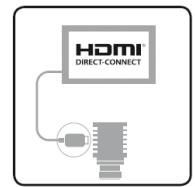
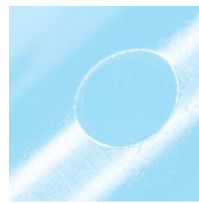

# Manual Ryf Remote Control for R-FHD-1080

## IV. Programming the Ryf OSD Remote Control no. R-FHD-1080

(Assigning camera an functions to the buttons)

In conjunction with the RFHD Ctrl Software, the Ryf Remote Control is designed to allow users to assign and control up to 12 camera function with the Remot unit

In order to assign the R-FHD camera functions to the remote control the user must open the Ctrl Software:

At the top of the **uCOM: Push Button** tab, the user can find the **single push** and **hold** option for External switch A through F. Therefore, every button on the remote control has a 2 function programming availability, thus making a total of 12 programmable functions.

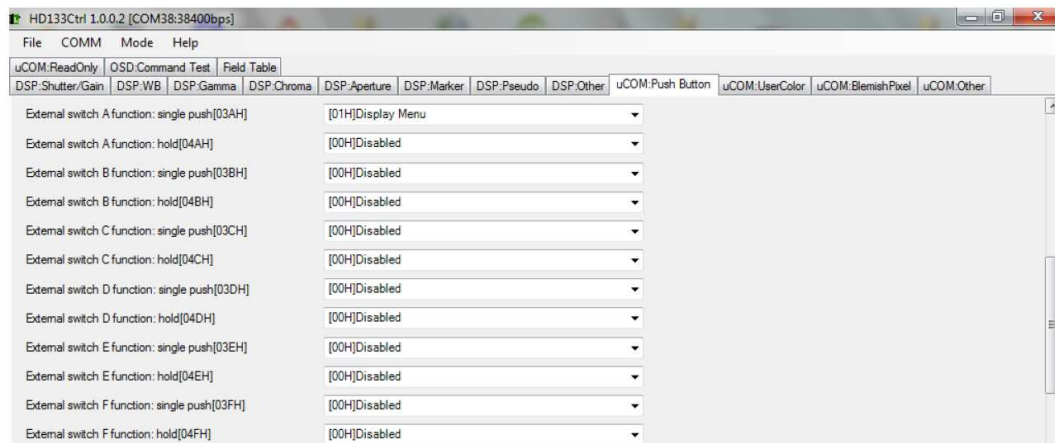

To assign camera functions to the External switch (buttons A-F), simply select the desired function in the adjacent scroll-down menu of the appropriate External switch.

Once all of the desired function assignments are made click the **uCOM→EEPROM** button at the bottom of the page. This will override the existing settings on the camera's EEPROM with the new settings.

**IMPORTANT:** When the setting changes are saved to the EEPROM, it is then necessary to turn the camera off and back on to begin using the new settings saved to the EEPROM.

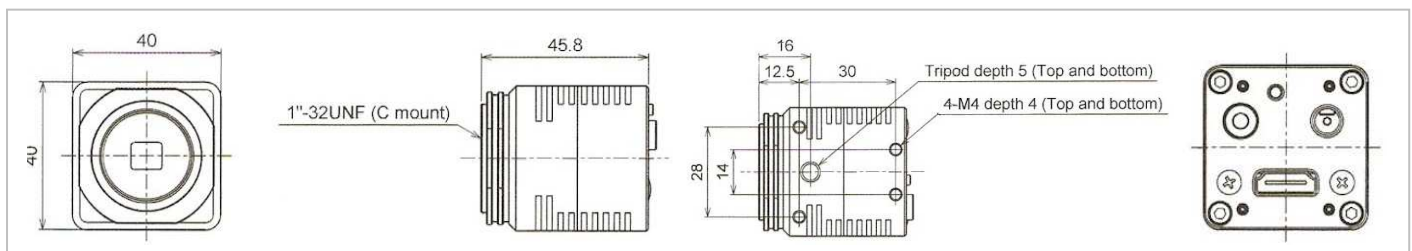

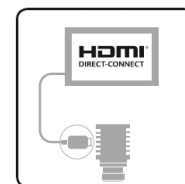
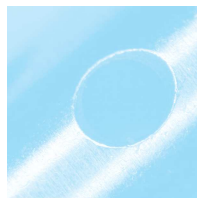

# Manual Ryf Remote Control for R-FHD-1080

## B. Assigning OSD Menu Navigation Functions to the Buttons

In conjunction with the Software the Ryf Remote Control for the R-FHD-1080 / R-HD720 camera is also designed to allow users to self-assign the keypad's navigation function for the OSD menu.

In order to assign the keypad navigation functions the users must first open the Software and in the second section of the uCOM: Push button tab, users can change the following functions:

- Menu: page decrement  
*NOTE: use only when an additional user-made board switch is connected to the camera or with the primary switch function (WB button). Failing to do so will cause one of the six standard navigation functions (up, down, left, right, turn-off, enter) to not have an assignment on the OSD remote control keypad.*
- Menu: page increment  
*NOTE: use only when an additional user-made board switch is connected to the camera or with the primary switch function (WB button). Failing to do so will cause one of the six standard navigation functions (up, down, left, right, turn-off, enter) to not have an assignment on the OSD remote control keypad.*
- Menu: down
- Menu: up
- Menu: right
- Menu: left
- Menu: turn off
- Menu: enter

To assign the OSD navigation functions to the keypad buttons click the adjacent scroll-down menu of the appropriate navigation function. Then click on one of the following selections in the scroll down menu:

Software Display	Remote Control Button
[OAH]A	: Button A
[OBH]B	: Button B
[OCH]C	: Button C
[ODH]D	: Button D
[OEH]E	: Button E
[OFH]F	: Button F

Once all the desired navigation assignments are made click the uCOM => EEPROM button of the page.

This overrides the existing settings on the Ryf FHD-1080 camera's EEPROM with the new settings.

**IMPORTANT:** when the navigation function settings changes are saved to the EEPROM, it is then necessary to turn the camera off and back on to begin using the new settings saved to the EEPROM.

Ryf AG 3/2015 www.ryfag.ch



Ryf AG  
Bettlachstrasse 2 · CH-2540 Grenchen  
Tel. 032 654 21 00 · Fax 032 654 21 09  
ryfag@ryfag.ch · www.ryfag.ch  
www.fotoryf.ch

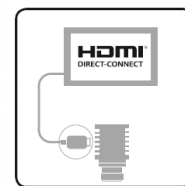
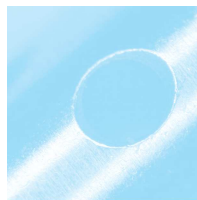

# ***Manual Ryf Remote Control for R-FHD-1080***